



# 12314 PROGRAMMABLE 12V HEAVY DUTY TIRE INFLATOR USER GUIDE

## THANK YOU FOR PURCHASING THE MICHELIN PROGRAMMABLE 12V HEAVY DUTY TIRE INFLATOR

Read the operating instructions before using the inflator. Improper use can cause damage or harm to you and/or your property. When using the inflator, park the vehicle in a safe location, off the roadway with the handbrake engaged.



Only suitable for vehicles with a negative ground. Check your vehicle owner's manual.



This inflator can inflate vehicle tires up to 45 PSI (please follow your vehicle manufacturer's recommendations) and bicycle tires up to 100 PSI.



Use the included adapters to safely inflate low-pressure items such as sports balls and small inflatable toys.

Max power requirement during normal use: 15A / 180W.



### WARNING! COMPRESSED AIR CAN BE DANGEROUS



The inflator should not be used by anyone unfamiliar or inexperienced with its use. Use with caution around children. The inflator is neither safe nor intended for use by children.



Never leave unattended when running.



Never overinflate.



Always use in a safe area away from traffic and other dangers.

Never run continuously for more than 10 minutes. After each 10-minute run allow inflator to cool for 10 minutes.



### WARNING! ENSURE CORRECT TIRE PRESSURES



Correct tire pressure is vital for road safety.



Under or overinflated tires can be dangerous.



Perform weekly checks to ensure tires meet manufacturer's recommended pressure. This should include the spare, but exclude space saver tires. Always check before a long distance trip or after loading or unloading the vehicle.



Always check air pressures in an ambient temperature, never immediately after a long distance trip.



### CAUTION



Inspect the inflator before each use.



The cigarette lighter power outlet should be dust and debris-free or overheating may result. If your 12V power outlet has a fuse rated at 10A or less, the wiring in your vehicle will not support this product.



Do not leave the device unattended whilst connected to 12V DC socket.



Do not kink or block the air hose while the inflator is in operation.



Do not use the inflator or any of its components if bent, broken, melted, burned or wet.



Only use the adapters supplied with the device.



The inflator contains no user serviceable parts – DO NOT OPEN.

## PROGRAMMABLE 12V HEAVY DUTY TIRE INFLATOR

### OPERATING FEATURES

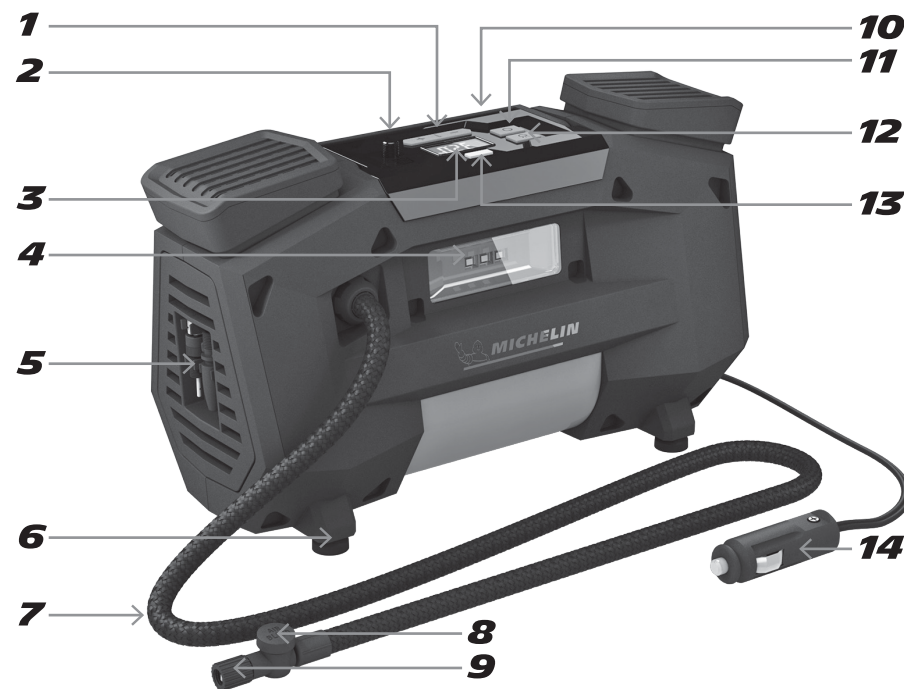

- |   |   |
|---|---|
| 1. Pressure pre-set buttons                     | 8. Bleed valve  |
| 2. Tire valve dust cap holder                   | 9. Tire valve connector                                     |
| 3. White LCD digital display                    | 10. Handle  |
| 4. Superbright LED Light                        | 11. On/Off button   |
| 5. Adapters (snap-in storage)                   | 12. LED Light On/Off button                                 |
| 6. Cushioned feet for stability                 | 13. PSI, BAR & kPa button / Reset button                    |
| 7. 33.4 inches (approx.) high-pressure air hose | 14. 9.1 feet (approx.) power cord with fused 12V power plug |

### SPECIFICATIONS

Max pressure:	Up to 45 PSI for vehicle tires, 100 PSI for bicycle tires
Pressure accuracy:	Backlit pressure gauge (+/- 1 PSI up to 50 PSI, +/- 2 PSI > 50 PSI to 80 PSI)
Pressure format:	PSI / BAR / kPa
Max current:	15A / 180W
Fuse size:	15A glass
Hose length:	33.4" (approx.)
Power cord:	9.1' (approx.)

## TO INFLATE VEHICLE TIRES

1. Unwind the power cord completely (14) and plug the power plug into your vehicle's 12V accessory socket (some vehicles may require the ignition to be on to supply power). After a few seconds, the digital display (3) will momentarily show all the digits and then return to 0.00. It is good practice to press and hold the reset button (13) for approx 5 seconds; all the digits will be displayed again momentarily and then return to 0.00.

2. Press the PSI, BAR & kPa button (13) to select the desired pressure format.

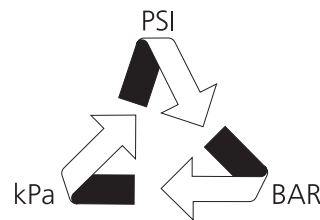

3. Remove the tire valve dust cap and store on the holder on top of the inflator (2). Make sure your tire valve is clean before removing the high pressure hose from its storage clip. **Note: always make sure you connect the 12V power plug before connecting the high-pressure hose to your tire valve.** Screw on the tire valve connector (9) — once connected, the digital display (3) will show your current tire pressure. If the display shows 0.00 or Err refer to the Trouble Shooting Guide. If this is the correct pressure stated in your vehicle's handbook, remove the tire valve connector (9) and replace your dust cap.

4. If the tire is below the recommended pressure (as specified in your vehicle's handbook) scroll up or down using the **[+ (or) -]** buttons (1) to set the correct tire pressure. Hold either button down for 1 second to quickly increase/decrease the pre-set pressure.

5. The high pressure air hose is fitted with a bleed valve (8) that allows you to lower the pressure of the tire if it goes above the recommended PSI. The digital display (3) will indicate when it reaches the correct pressure.

6. Switch on the inflator. The tire which will now inflate to the selected pre-set pressure. The inflator may continue to run for a few seconds when it has reached the selected pressure, this is a feature of the built-in pressure sensor to ensure the correct pressure has been reached. Note: Although the inflator is fully automatic do not leave unattended whilst it is inflating.

7. If you are inflating multiple tires follow steps 3 to 6 above. If the 12v power supply (14) is disconnected, always reconnect the 12V power supply (14) before connecting the high pressure air hose (7) to the tire valve. Remember, you may have to reset the pre-set pressure as some vehicles have different pressures between front and rear tires, (as specified in your vehicle's handbook). If there is a power interruption during the inflation cycle, follow the reset procedure outlined in the Trouble Shooting Guide.

**Note: The inflator will default to the PSI pressure format when the unit has been removed from the power source.**

ADAPTERS

Included with your MICHELIN Programmable 12v Heavy Duty Tire Inflator are various adapters to enable you to inflate other items. These are housed at the end of the unit (5).

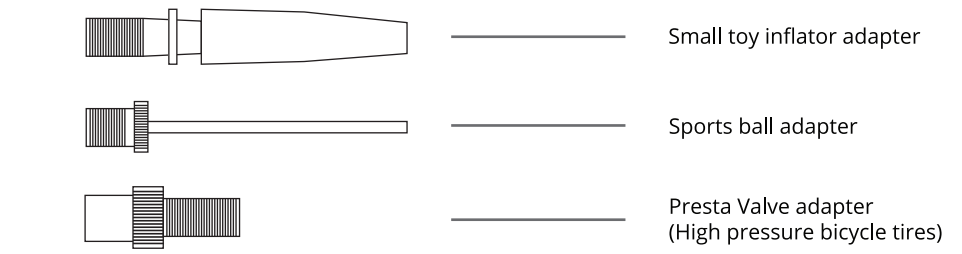

12V POWER PLUG

TO REPLACE THE FUSE IN THE 12V PLUG:

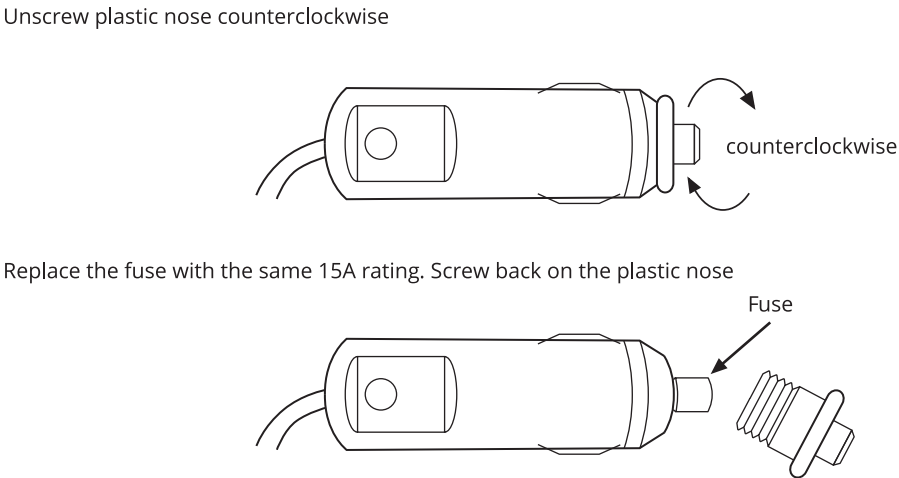

TYPICAL INFLATION PRESSURE

	5 - 13 PSI
	22 PSI
	35 - 50 PSI (Mountain bike) 90 - 100 PSI (Road bike)
	34 PSI
	28 - 40 PSI

CONVERSION CHART

PSI	BAR	kPa
10	0.69	69
20	1.38	138
30	2.07	207
40	2.76	276
50	3.45	345
60	4.14	414
70	4.83	483
80	5.52	552
90	6.21	621
100	6.89	689

TROUBLESHOOTING

<b>Gauge does not illuminate</b> <b>Unit fails to run with switch in 'On' position</b>	<ul style="list-style-type: none"><li>■ Check that the plug is fully inserted into the 12V socket.</li><li>■ Check internal fuse (15A glass type).</li><li>■ Your car may require the ignition key to be turned to the accessory position.</li></ul>
<b>Unit fails to stop at pre-set</b>	<ul style="list-style-type: none"><li>■ Check you are following the setting instructions correctly.</li><li>■ Check that you have set the correct pre-set pressure.</li></ul>
<b>Power lead/plug becomes hot</b>	<ul style="list-style-type: none"><li>■ If power lead is coiled, uncoil to full length.</li><li>■ Ensure 12V socket is clean with no debris in it.</li><li>■ Ensure 12V plug components are tight and clean.</li></ul>
<b>Gauge appears to read incorrectly or is unreadable</b> <b>Gauge reads 0.0 or ERR</b>	<ul style="list-style-type: none"><li>■ When the tire valve connector is attached, before switching the unit on, ensure the gauge is reading your current tire pressure.</li><li>■ Disconnect valve connector from the tire. Remove plug from power source for at least 5 seconds, reconnect to power.</li><li>■ Press and hold yellow reset button (13) until display shows all the digits then returns to 0.0.</li><li>■ Connect valve connector to tire.</li></ul>
<b>Unit is running but tire is not inflating</b>	<ul style="list-style-type: none"><li>■ Check that the tire valve connector is correctly fitted to the tire valve.</li></ul>
<b>Gauge does not display when tire valve is connected</b>	<ul style="list-style-type: none"><li>■ Ensure tire valve is correctly connected to the tire valve connector.</li></ul>
<b>Unit displays ERR message</b>	<ul style="list-style-type: none"><li>■ Connect the 12V power plug to the vehicles 12V supply. Do not connect the valve connector to the tire valve. Allow the gauge to settle for a few seconds, press and hold the yellow reset button (13) for 5 seconds. This will reset the pressure sensor.</li></ul> <p>If the problem persists the pressure sensor has failed - Please contact the Michelin helpline.</p>
For all other issues please call customer support: +1(800) 403-0471	

OTHER MICHELIN PRODUCTS AVAILABLE



LI-ION RECHARGEABLE VEHICLE INFLATORS  
TIRE PRESSURE GAUGES

Scan the QR code to access further product information.

Customer inquiries:  
We're at your service. Let us help you, find a better way forward.  
Customer support:  
+1(800) 403-0471  
Michelin@tire-inflation.com

MICHELIN and/or the Michelin Man Device and/or BIBENDUM are trademark(s) owned by, and used with the permission of, the Michelin Group. © 2023 Michelin  
Manufactured and distributed under license by Enrich International Company Ltd.  
US representative office:16720 Chestnut Street #C City of Industry, CA 91748, USA

PLEASE RETAIN THESE INSTRUCTIONS FOR FUTURE REFERENCE