



5-99 PSI



BATTERIES
INCLUDED



NIGHT TIME
ILLUMINATION



27000 TIRE TREAD DEPTH &
PRESSURE GAUGE
USER GUIDE

**THANK YOU FOR PURCHASING THE
MICHELIN TIRE TREAD DEPTH AND
PRESSURE GAUGE**

**TIRE PRESSURE ADVICE
AND ACTIONS**

Always follow the vehicle manufacturer's tire pressure recommendations which are based on cold tire temperatures. In addition, keeping your tires at the correct pressure and using energy efficient tires reduces fuel consumption and reduces CO² emissions. Inflation pressures for all the tires on the vehicle (including the spare tire) should be checked monthly and before any long trips. Find the correct tire pressure on the placard found on the door pillar, inside the fuel filler cap, or in the vehicle handbook.

Tire pressures should be checked when the tires are cold, meaning that the tires have not run for at least 3 hours or have been driven less than 1 mile at moderate speed.

Tire pressures increase while the vehicle is being driven, which is normal. If the pressure is checked after the vehicle has travelled a sufficient distance to heat up, it could be 4-5 PSI higher than the recommended cold pressure.

Never deflate tires to the recommended cold pressure when they are hot. If you intend to tow with the vehicle, e.g., a trailer, always consult the vehicle handbook, trailer or tire manufacturer for suggestions, as increased tire inflation pressures may be required. Don't forget to check the inflation pressure and the condition of the tires on the trailer.

MEASURING TIRE PRESSURE

1. Press the On/ function button (1) to turn on the gauge. The display will first flash a full screen 8.8.8.8 and the light will illuminate.
2. To select between formats and units a repeated short press of the On/function button will scroll through formats; pressure: PSI/BAR/kPa/kgf/cm²) and tread: mm/inches.

3. If the last measurement mode was **tread depth mode** 0.0, 0.00 (mm/inches), press the On/function button again to enter tire pressure mode and select the required pressure format with a repeated short press of the On/function button.

Note: the gauge will automatically switch off after approx. 30 seconds if no further action is taken.

4. Remove the tire valve cap and store safely, then push and hold the gauge nozzle (3) onto the valve stem, making sure a good seal is made between the nozzle and the valve stem so that no hissing sound of escaping air is heard from the valve. Hold the gauge on the valve stem tightly until the pressure reading is displayed.

5. After the reading has locked on the display, quickly remove gauge from the valve stem.

6. The pressure reading will show (stay) on the screen for about 30 seconds.

7. To change the unit of pressure showing on the screen, press the On/function button repeatedly to scroll through the units; PSI/BAR/kPa/kgf/cm²).

MICHELIN TIRE TREAD DEPTH & PRESSURE GAUGE

OPERATING FEATURES

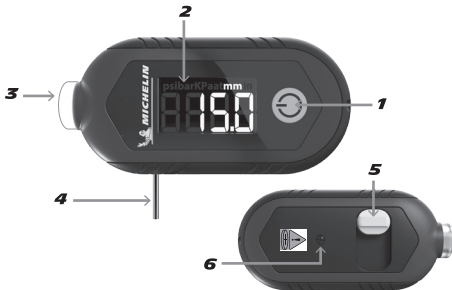

1. On/Function button
2. Large LCD digital display
3. Flashlight/gauge nozzle
4. Tread depth pin
5. Yellow button
6. Battery tray screw



SPECIFICATIONS

Tire pressure range:
Tire pressure resolution:
Tire pressure accuracy:
Tread depth range:
Tread depth resolution:
Tread depth accuracy:

2-150 PSI, 0.13-10.3 BAR 13-1034 kPa, 0.14-10.5 kgf/cm² (displayed as at)
0.5 PSI, 0.05 BAR, 5 kPa, 0.05 kgf/cm²
+/- 1 PSI up to 50 PSI, +/- 2 PSI 51 to 100 PSI, +/- 3 PSI 101 to 150 PSI
0-0.59 inches, 0-15mm
0.003 inch, 0.1mm
+/- 0.019 inch, +/- 0.5mm

HOW TO CHECK YOUR TIRE TREAD WEAR LEVELS

Because the tires are the only part of the vehicle that grip the road, the depth of tread on your tires is very important for the safety of your vehicle.

Step 1 - Access the Tire Tread

This first step in checking tire tread depth is gaining safe and clear access to your tires.

1. Park on a wide, flat and even surface in a safe place with the engine switched off.
2. Put the hand brake on, and engage first gear (for manual gearboxes) or park (for automatics).
3. Once you have clear and safe access to the tires you can begin the inspection.

MEASURE ALL TREAD GROOVES

Fig 1

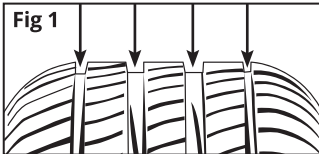

Step 2 - Check the tread

With the tire tread easily accessible, you can begin to check the depth of the tread and condition of the tire. With this simple device, measuring tread depth is not difficult, and only requires a few minutes of time.

Your vehicles tire tread depth should conform to the State/Province or local laws of the area where you live or operate your vehicle.

Check the depth of the main tread grooves in several places across and around the tire (Fig 1). In addition, most car tires now have tread wear indicators set into the tread grooves (Fig 2), which show when the tire is worn to approximately 0.062 inches, approx 1/16th (1.6mm) of the remaining tread. When these wear indicators become level with the tread surface, your tires should be changed immediately. On a Michelin tire, the position of the tread wear indicators is shown by a molded in Michelin Man in the side wall shoulder area of the tire. Tire tread depth is only an indicator of a tire's suitability for further service. If your tire tread depths are approaching the legal limit or if you have any doubts, get them checked by a tire specialist.

TREAD WEAR INDICATOR

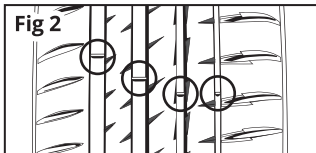

When measuring tread depth make sure the gauge is positioned as shown in the following diagram Fig 3.

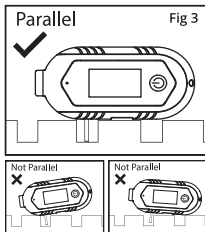

MEASURING TREAD DEPTH

Press the On/function button to activate the tire gauge. The display will first flash a full screen, 8.8.8.8.

2. Depending on the last measurement mode and unit icon, the screen will display 0, 0.0 or 0.00.

3. If the last mode is pressure mode, press On/function button again to enter tread depth mode displayed as 0.00 with in above or 0.0 with mm above.

4. Slide the yellow button (5) down on the back until it stops. The metal pin (4) is now visible. Now push the gauge towards the tire, locating the pin in the tire tread groove, and slowly push the gauge towards the tire surface until it stops. Making sure the gauge sits flat and parallel on the tire surface as indicated in Fig 3.

5. Remove the gauge from the tire and read the display. **Note:** The measurement will change if the yellow button is moved during this time. Make sure not to touch or move the yellow button when removing the gauge from the tire.

6. **IMPORTANT:** To take the next measurement repeat from step 4 above. Failure to slide the yellow button back down before making contact

with the tire will give an incorrect reading.

7. Once you have finished taking measurements, slide the yellow button up until it stops and the metal pin is no longer visible.

If for any reason you see a minus measurement on the display retract the pin with the yellow button. Turn the gauge off by pressing and holding the On/function button. Then switch the gauge on again before starting at step 4 again.

Note: The gauge will automatically turn off in 30 seconds. You can override this and turn the gauge off by pressing and holding the On/function button down until the display switches off.

Note: It is important to remember that this tread depth gauge is for guidance only. If your tires are close to the legal minimum, you should get them checked by a professional tire dealer.

ADVICE

1. Always follow the vehicle manufacturer's pressure recommendation, which is based on cold tire temperature.

2. Use a soft damp cloth to clean your gauge. Do not use any liquids or cleaners.

3. Use a tire gauge every 4 weeks and top up the pressure in your tires with a MICHELIN tire inflator to reduce fuel consumption, increase tire life and reduce CO² emissions.

Replacing the Batteries

If LOB (low battery warning) is displayed, the batteries should be replaced.

To replace the batteries, remove the screw from the rear of the unit. Turn the unit over and pull the rear of the unit backwards exposing the battery tray/batteries, Fig 4. Replace the batteries and reverse the sequence.

Immediately recycle or dispose of used batteries according to local regulations and keep away from children.

Do NOT dispose of batteries in household trash or incinerate. Even used batteries may cause severe injury or death.

Call a local poison control center for treatment information.

The battery type is CR2032, 3.0V/210mAh.

Non-rechargeable batteries are not to be recharged.

Do not force discharge, recharge, disassemble, heat above 60°C (manufacturer's specified temperature rating) or incinerate. Doing so may result in injury due to venting, leakage or explosion resulting in chemical burns. Ensure the batteries are installed correctly according to polarity (+ and -). Do not mix old and new batteries, different brands or types of batteries, such as

alkaline, carbon-zinc, or rechargeable batteries. Remove and immediately recycle or dispose of batteries from equipment not used for an extended period of time according to local regulations. Always completely secure the battery compartment. If the battery compartment does not close securely, stop using the product, remove the batteries, and keep them away from children.



WARNING

- **INGESTION HAZARD:** This product contains a button cell or coin battery. • **DEATH** or serious injury can occur if ingested.
- A swallowed button cell or coin battery can cause **Internal Chemical Burns** in as little as **2 hours**.
- **KEEP** new and used batteries **OUT OF REACH** of **CHILDREN**.
- **Seek immediate medical attention** if a battery is suspected to be swallowed or inserted inside any part of the body.



TROUBLESHOOTING

If the display is blank

- Make sure that the pressure seal between the tire gauge and the valve stem is free from leaks.

If the unit has an unusually high or low reading

- Check to make sure that there are no leaks in the system. Re-zero the gauge by pressing and holding the on/function button to force a shut-down and then restart with the on/function button.

If the display reads LOB

- The batteries are exhausted and must be replaced.

If the display shows a minus measurement

- Retract the pin with the yellow button and turn the gauge off by pressing and holding the on/function button. Then switch the gauge on again before starting at step 4 again.

For all other issues please call
customer support: +1(800) 403-0471

FCC Warning Statement

Changes or modifications not expressly approved by the party responsible for compliance could void the user's authority to operate the equipment. This equipment has been tested and found to comply with the limits for a Class B digital device, pursuant to Part 15 of the FCC Rules. These limits are designed to provide reasonable protection against harmful interference in a residential installation. This equipment generates uses and can radiate radio frequency energy and, if not installed and used in accordance with the instructions, may cause harmful interference to radio communications. However, there is no guarantee that interference will not occur in a particular installation. If this equipment does cause harmful interference to radio or television reception, which can be determined by

turning the equipment off and on, the user is encouraged to try to correct the interference by one or more of the following measures:

- Re-orient or relocate the receiving antenna.
- Increase the separation between the equipment and receiver.
- Connect the equipment to an outlet on a circuit different from one that the receiver is connected.
- Consult the dealer or an experienced radio/TV technician for help.

This device complies with part 15 of the FCC rules. Operation is subject to the following two conditions (1) this device may not cause harmful interference, and (2) this device must accept any interference received, including interference that may cause undesired operation.

Scan the QR code to access further product information.



Customer Inquiries:

We're at your service. Let us help you, find a better way forward.

Customer support:

+1(800) 403-0471

Michelin@tire-inflation.com

MICHELIN and/or the Michelin Man Device and/or BIBENDUM are trademark(s) owned by, and used with the permission of, the Michelin Group. © 2024 Michelin
Manufactured and distributed under license
by Enrich International Company LTD.
16720 Chestnut Street #C City of Industry, CA 91748, USA

**PLEASE RETAIN THESE INSTRUCTIONS
FOR FUTURE REFERENCE**



One (1) year Limited Warranty



Made in Vietnam